

byBES Breezi

Activity Chair Range

MADE BY 
B | E | S
 HEALTHCARE

How to Fit Contour Back

(and/or with Chest Strap)

(and/or with Flat Head Support)

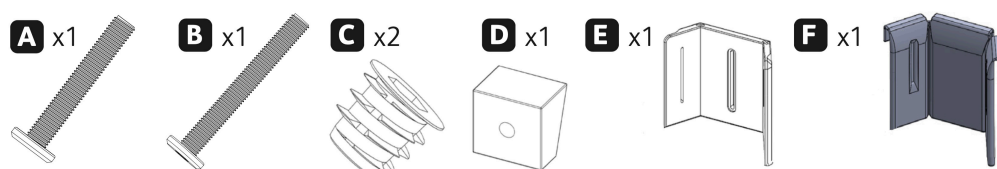
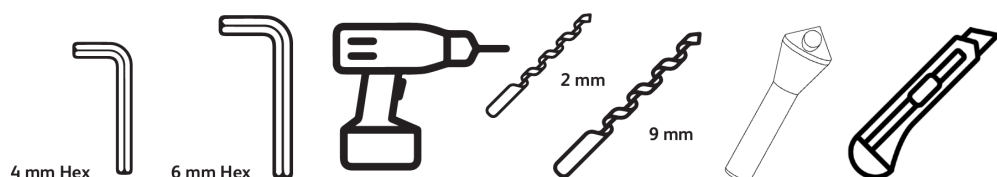

Optional

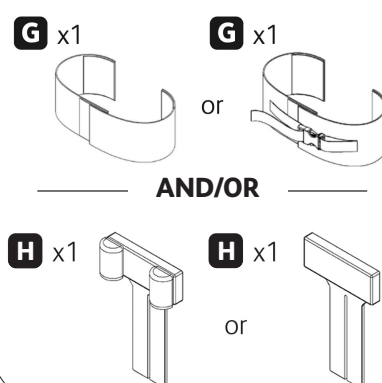

Steps 1 to 2 Drilling the chair backrails

Steps 3 to 4 Preparing the chair backrails

Steps 5 Fitting the Contour Back

Steps 6 to 8 Fitting the Chest Strap / Baby Chest Strap (optional)

Steps 9 Fitting the Head Support (optional)

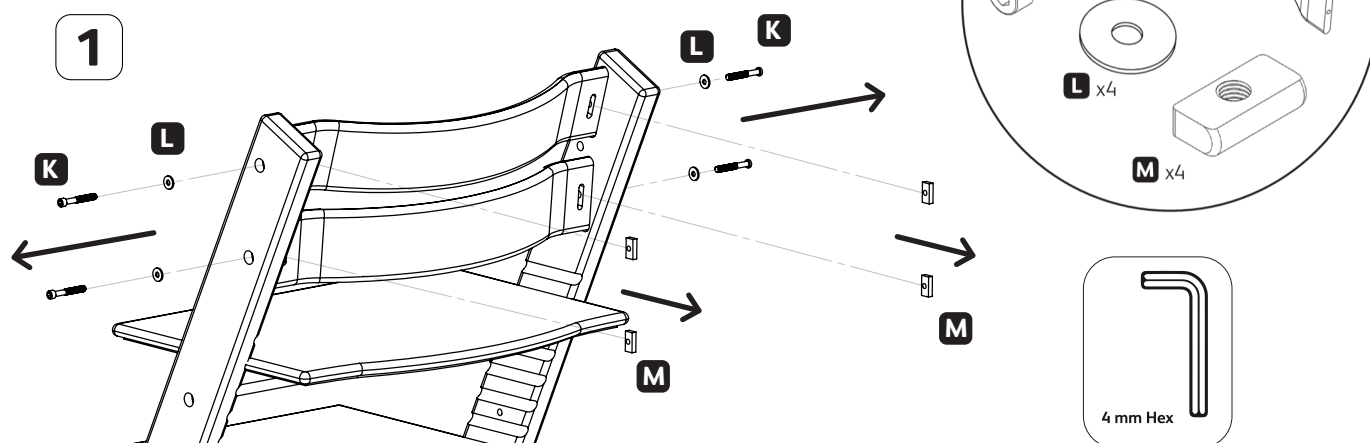

BES Healthcare Ltd +44 (0) 117 966 6761 info@beshealthcare.net www.beshealthcare.net

131 South Liberty Lane, Ashton Vale, Bristol, BS3 2SZ UK © 2025

byBESIn142 How to Fit Contour Back 20250601 V1



2

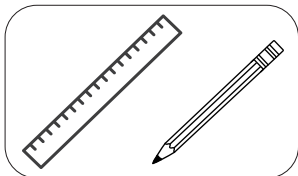

1



OR

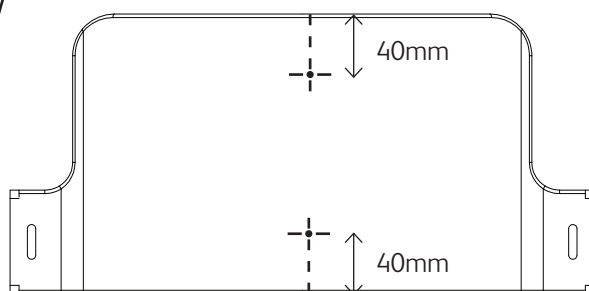

2.1



2.2

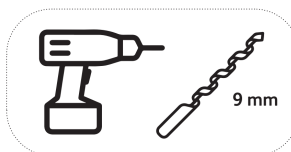

2.3

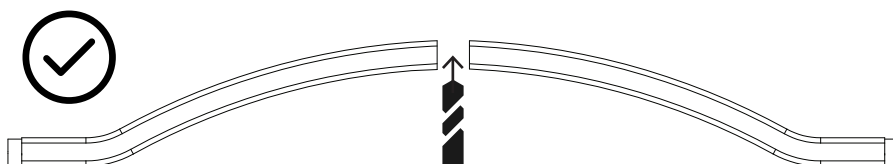
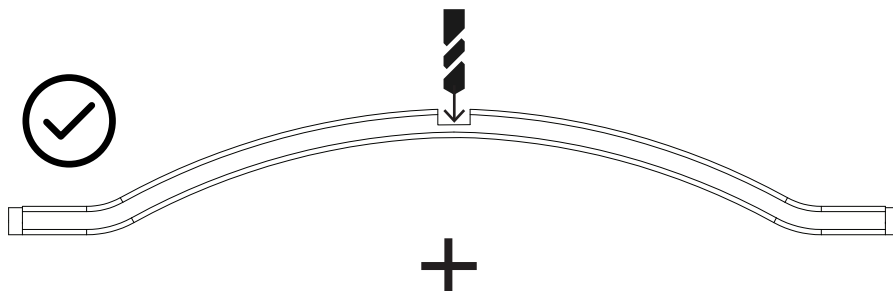
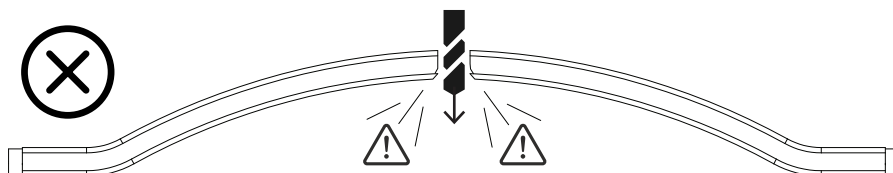

1

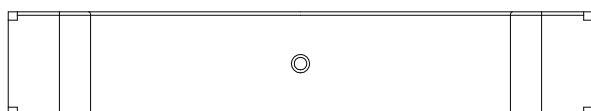

OR

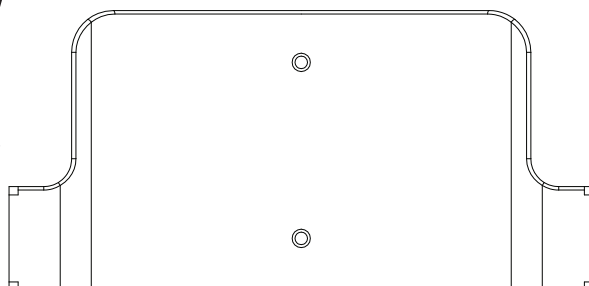

3

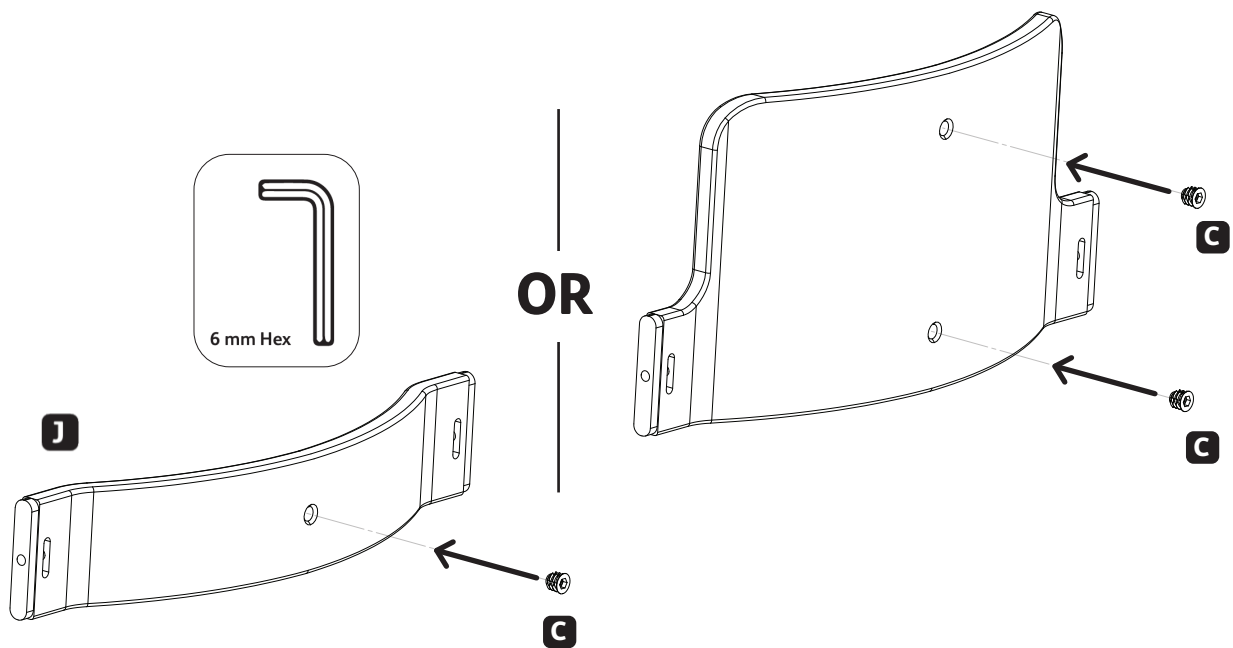

4

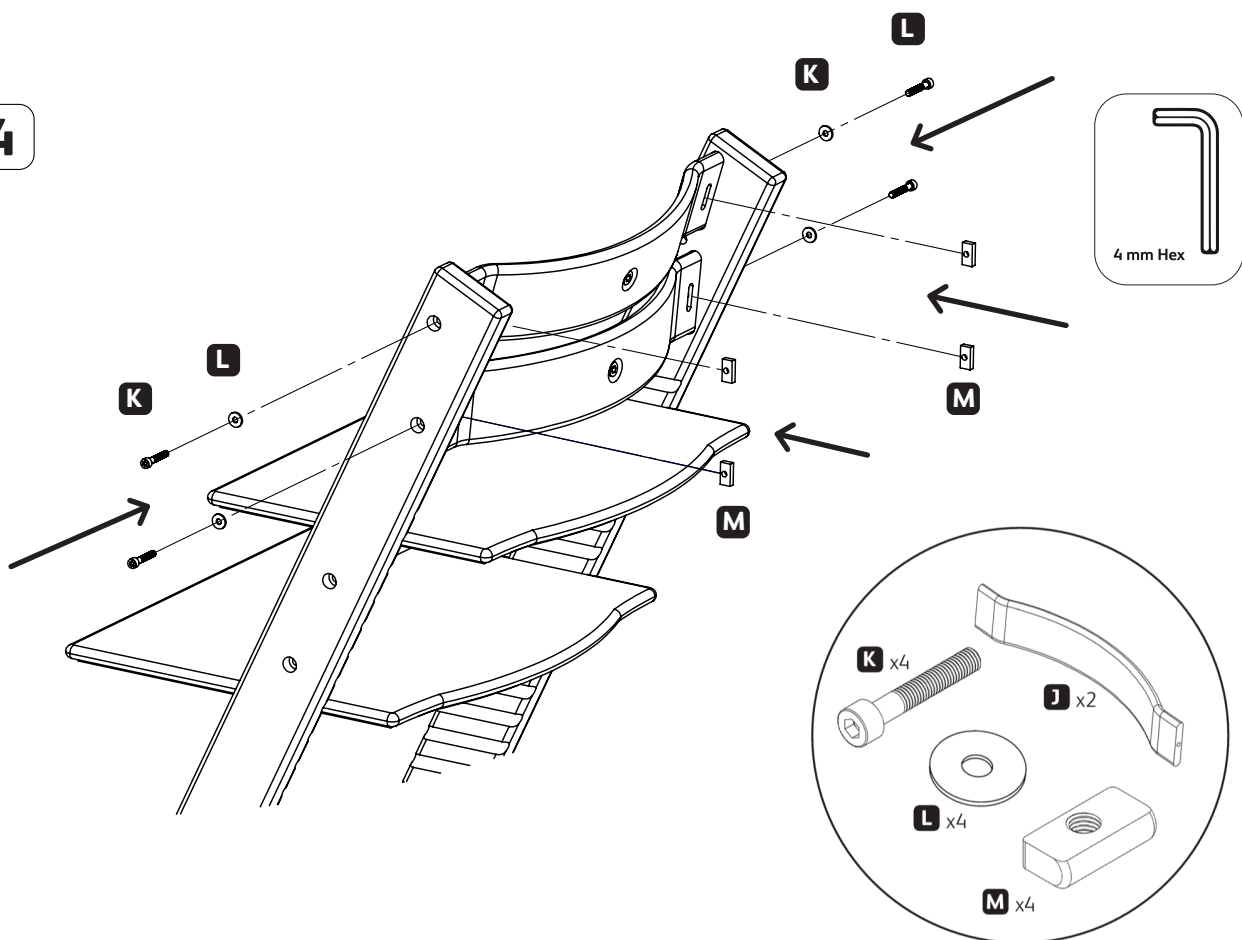

5

How to Fit Contour Back

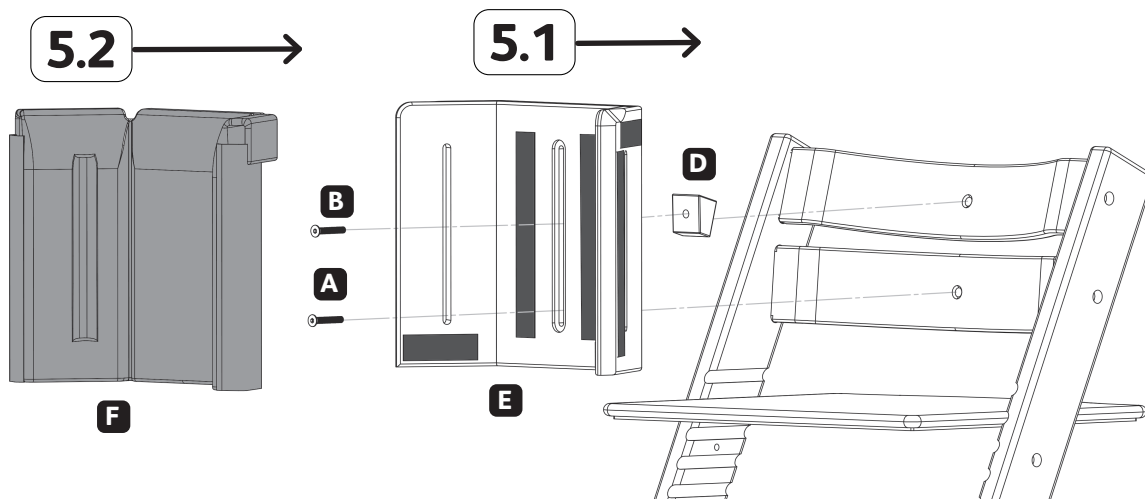

OR

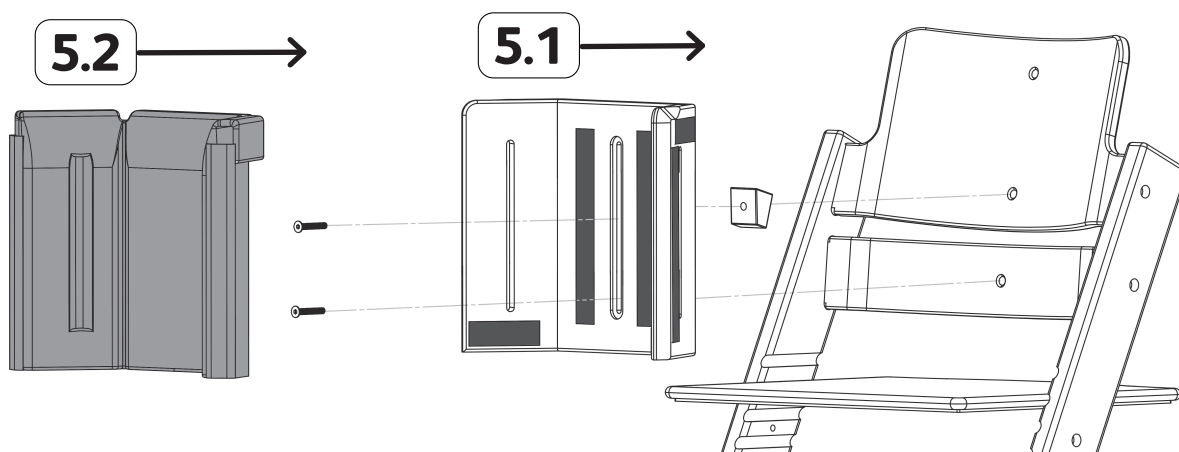

OR

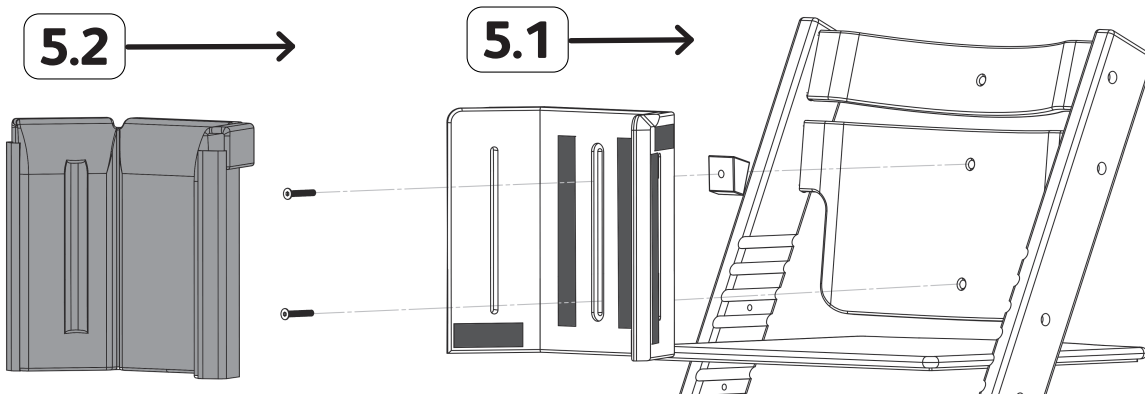

AND/OR

With Chest Strap / Baby Chest Strap

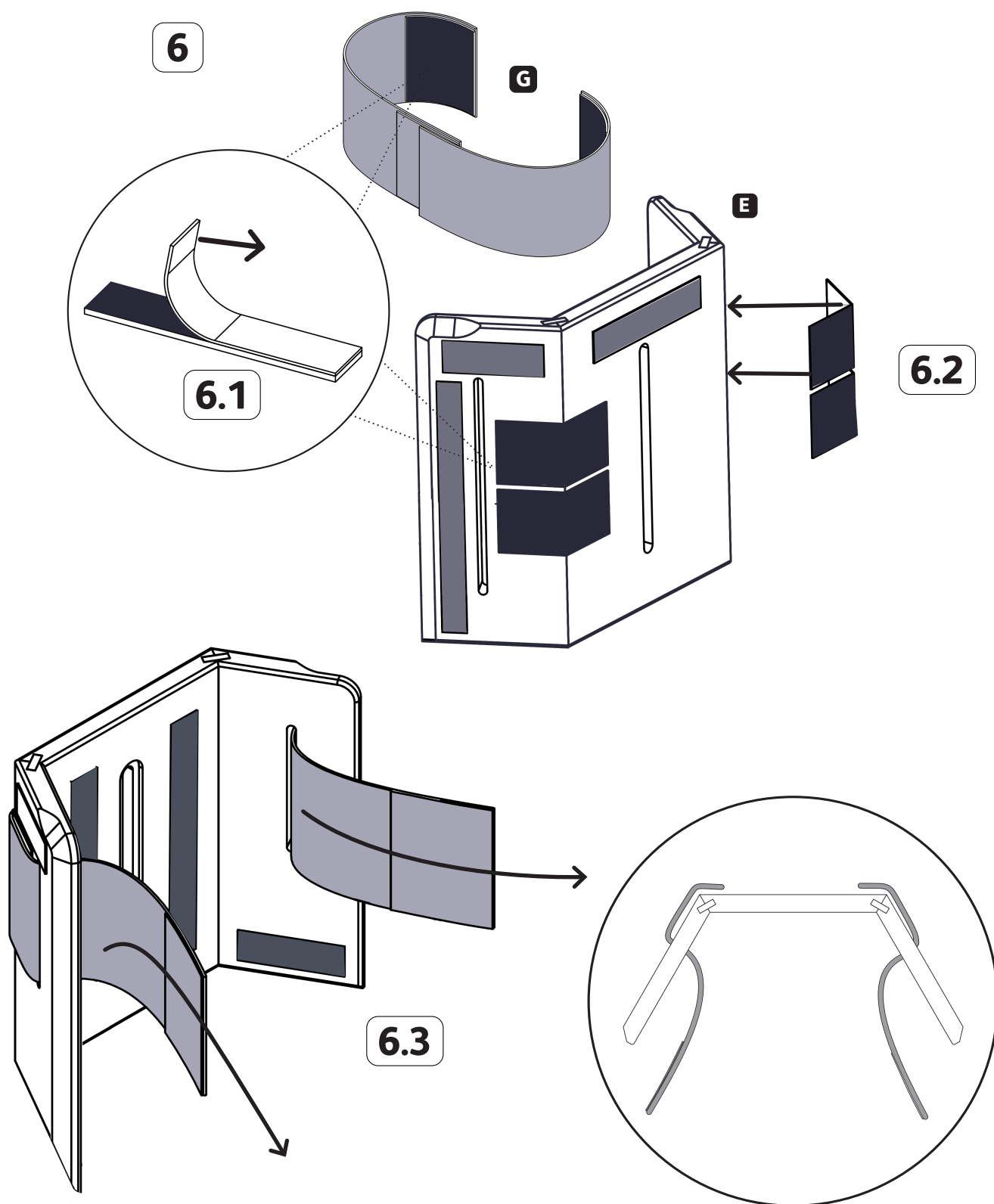

7

F

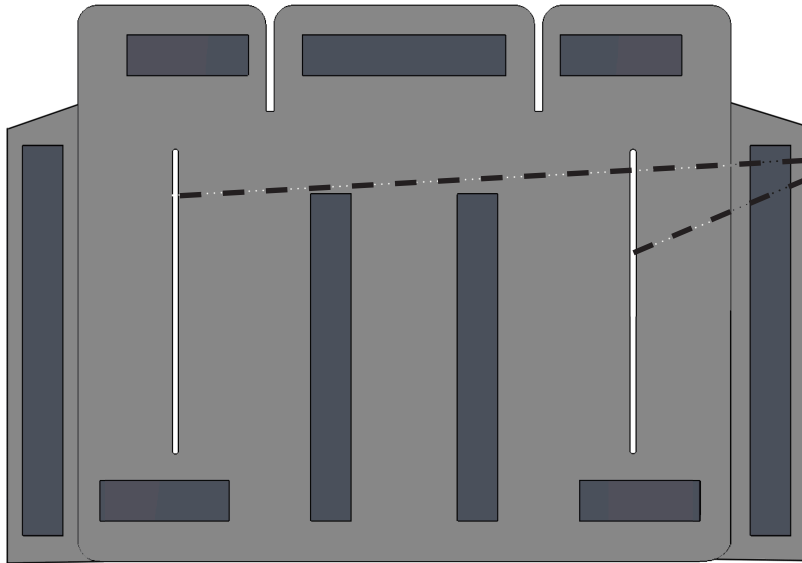

8

8.2

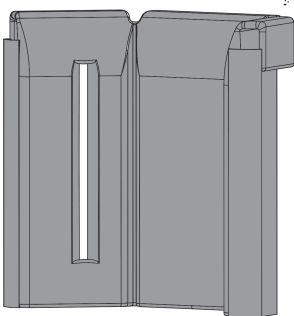

8.1

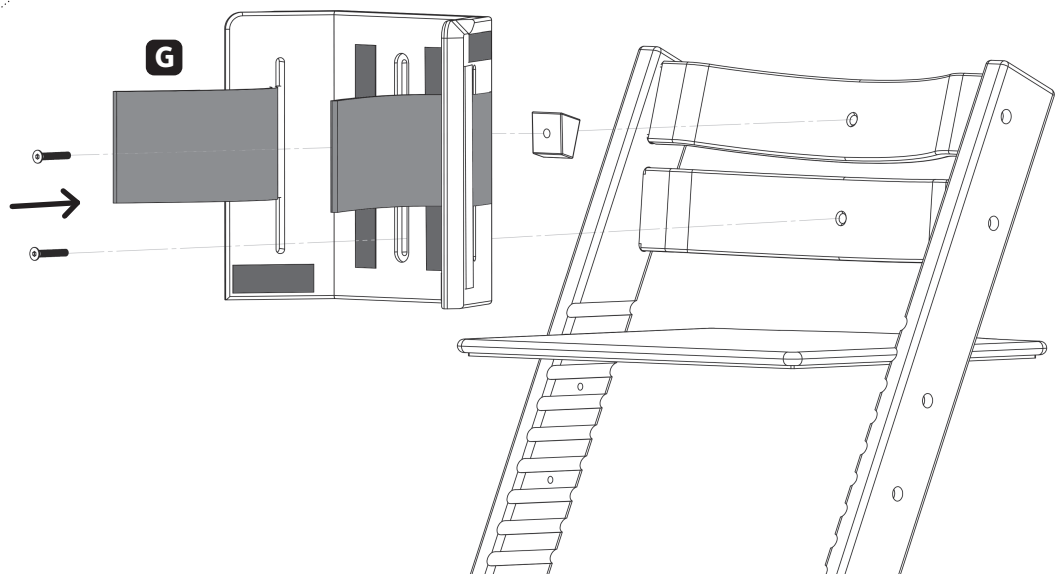

AND/OR

With Flat Head Rest

9

